

*401 Technology Dr
Southpointe, PA*



FOR LEASE 5,760 SF

401 Technology Drive, Southpointe/Canonsburg, PA 15317

Corner Office Suite

Efficient Floorplans with Common Area Café

Open with Abundant Natural Light

Aggressive Lease Terms and Full-Service Rental Rates

Outdoor Picnic Area

Discounted Membership at Adjacent Health Club of Southpointe Fitness Center

*Please visit www.healthclubatsouthpointe.com for more information about the fitness center.



5,760 SF SUITE 105

Corner Office Suite

Open Floorplan

Abundant Natural Light

Will Build to Suit

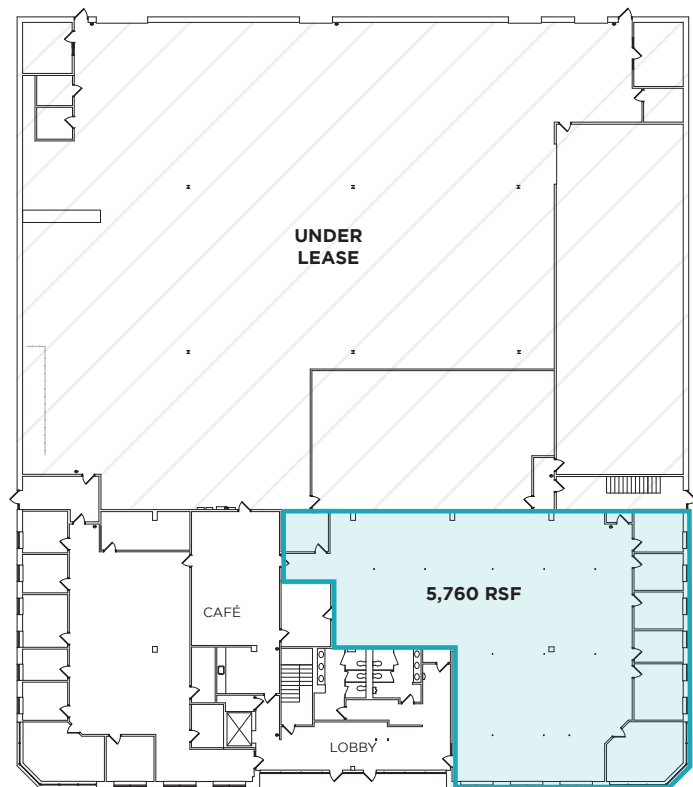

CONTACT BROKER

Kelley Hoover Heckathorne
412.670.4248
khoover@burnsscalo.com