

# 121 HILLPOINTE DRIVE

CANONSBURG, PA 15317



## 3,291 - 7,585 SF FOR LEASE

PREMIER SOUTHPOINTE OFFICE



- Ground Floor Suites Available
- Full First Floor Available
- Newly Renovated Office Suites
- Building Access 24/7/365
- Free and Convenient Parking
- Walk to Southpointe Town Center
- Sidewalks Throughout Park

KELLEY HECKATHORNE

+1 412 670 4248

khoover@burnsscalo.com

**NAI Burns Scalo**

COMMERCIAL REAL ESTATE SERVICES, WORLDWIDE



**First Floor, Suite 700**  
**7,585 RSF**

- Class A Office Space
- Window Walled Offices
- End Suites with Windows
- 10' Ceilings
- Private, Separate Entrance
- 9 Offices
- 2 Conference Rooms

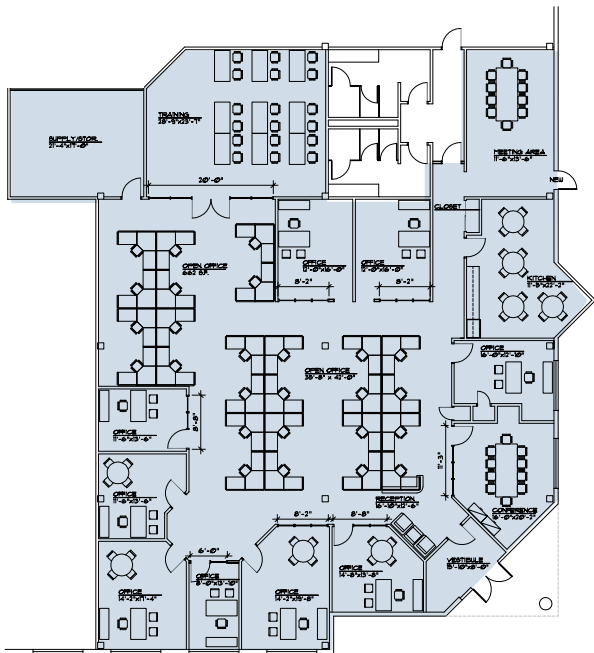

**First Floor, Suite 250**  
**3,291 RSF**

- Newly renovated
- Move in Ready Suite
- 4 offices
- Conference Room
- Kitchen
- Private, Separate Entrance
- 10' ceilings

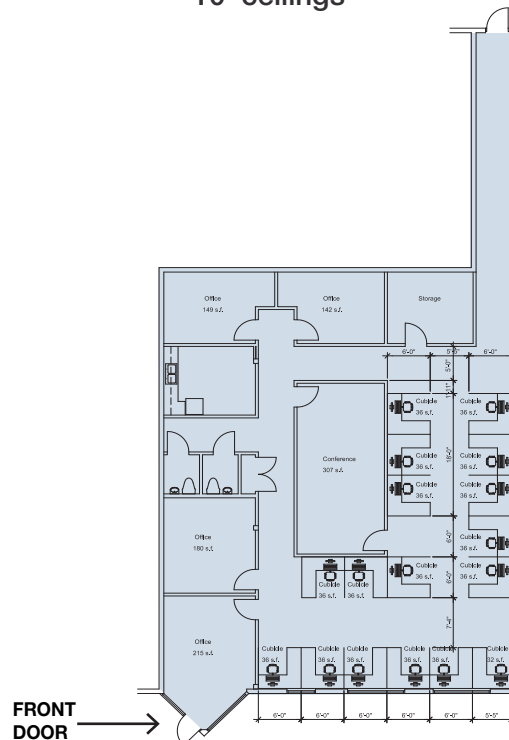

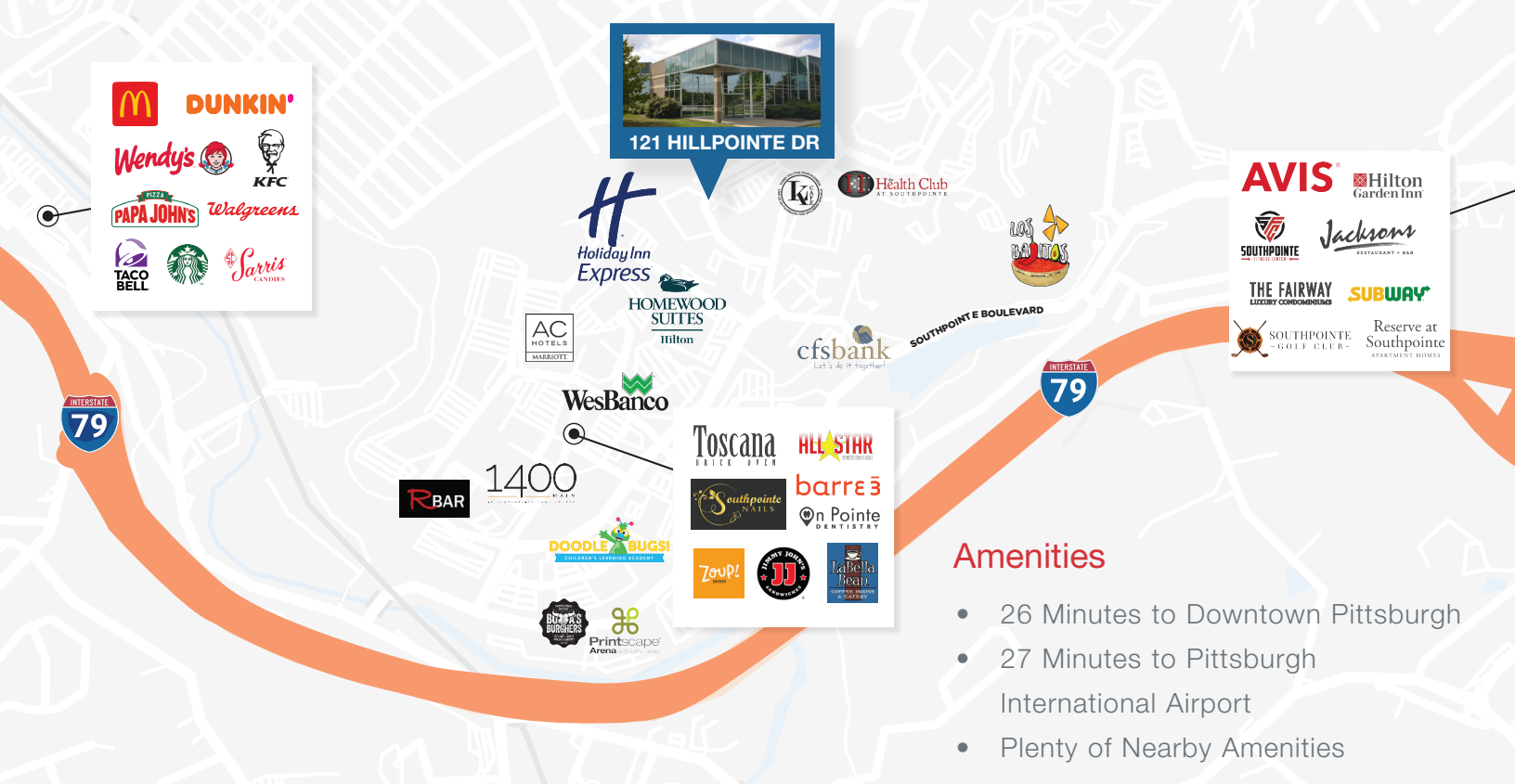

### Amenities

- 26 Minutes to Downtown Pittsburgh
- 27 Minutes to Pittsburgh International Airport
- Plenty of Nearby Amenities



**KELLEY HECKATHORNE**  
 +1 412 670 4248  
 khoover@burnsscalo.com

